



TESTING KITS FOR DRUGS

# Procedure Card for IDT5500T

## METHAMPHETAMINE CONFIRMATION

### Substance & Trace Test



#### Read Before Use

As a precaution, gloves and eye protection should be worn when handling drug substances and using test units. Do not puncture any part of unit. Do not remove probe once a capsule is broken. In the unlikely event of a spill, rinse affected area thoroughly with water. Keep out of reach of children. All results are presumptive. If necessary, further testing by a competent drug testing lab can provide additional identification.

#### Testing Options

**Confirmation:** This kit can be used to confirm Methamphetamine and distinguish between Methamphetamine and Amphetamine, if a positive result was given by the *Amphetamine/Methamphetamine Identification Test (IDT5000)*.

**Identification:** This kit can also be used by itself to test powders, traces, and liquids for the presence of Methamphetamine or Ecstasy/MDMA.

#### Test Preparation

1

Remove the Smart-Tip™ probe from test unit.



2

Sample suspected substance.

#### Powder

Swipe the paper of the Smart-Tip™ probe across the suspect substance.

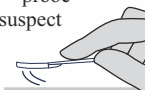

#### Liquid

Place the absorbent paper of Smart-Tip™ probe into liquid. Make sure paper is wet.



#### Test Preparation

3

Lock Smart-Tip™ probe into test unit. Press firmly.

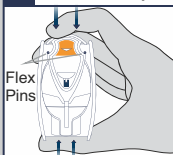

Flex Pins

STOP

**Do not continue unless probe is locked below the Flex Pins and cannot be removed from the test unit.**

#### Identification/Confirmation

4

With **thumb and forefinger**, squeeze chamber 1 until capsule breaks.

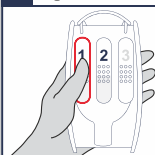

5

Gently shake test unit for 2-3 seconds.



#### Identification/Confirmation

6

With **thumb and forefinger**, squeeze chamber 2 until capsule breaks.

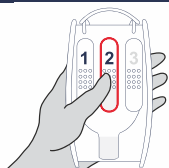

7

Gently shake test unit for 2-3 seconds.



#### Results

The appearance of a blue color in either the front or back window indicates the presence of **Methamphetamine** or **Ecstasy/MDMA**.



**Confirmation:** If this test is being used as a confirmation test for a **positive** result of *Amphetamine/Methamphetamine Identification Kit (IDT5000)*, the appearance of a blue color strongly indicates the presence of **Methamphetamine**.

If after a minute no blue color has appeared or a pink color appears, Methamphetamine and Ecstasy/MDMA are **not** present.



**Confirmation:** If this test is being used as a confirmation test for a **positive** result of *Amphetamine/Methamphetamine Identification Kit (IDT5000)* and a blue color does not develop within a minute, this indicates the presence of **Amphetamine**.

\* Note: This test will **not** react to Amphetamine nor MDA.



#### Disposal

The test kit is safe to dispose of in the trash.